

Installation

Inverted roof with level access threshold

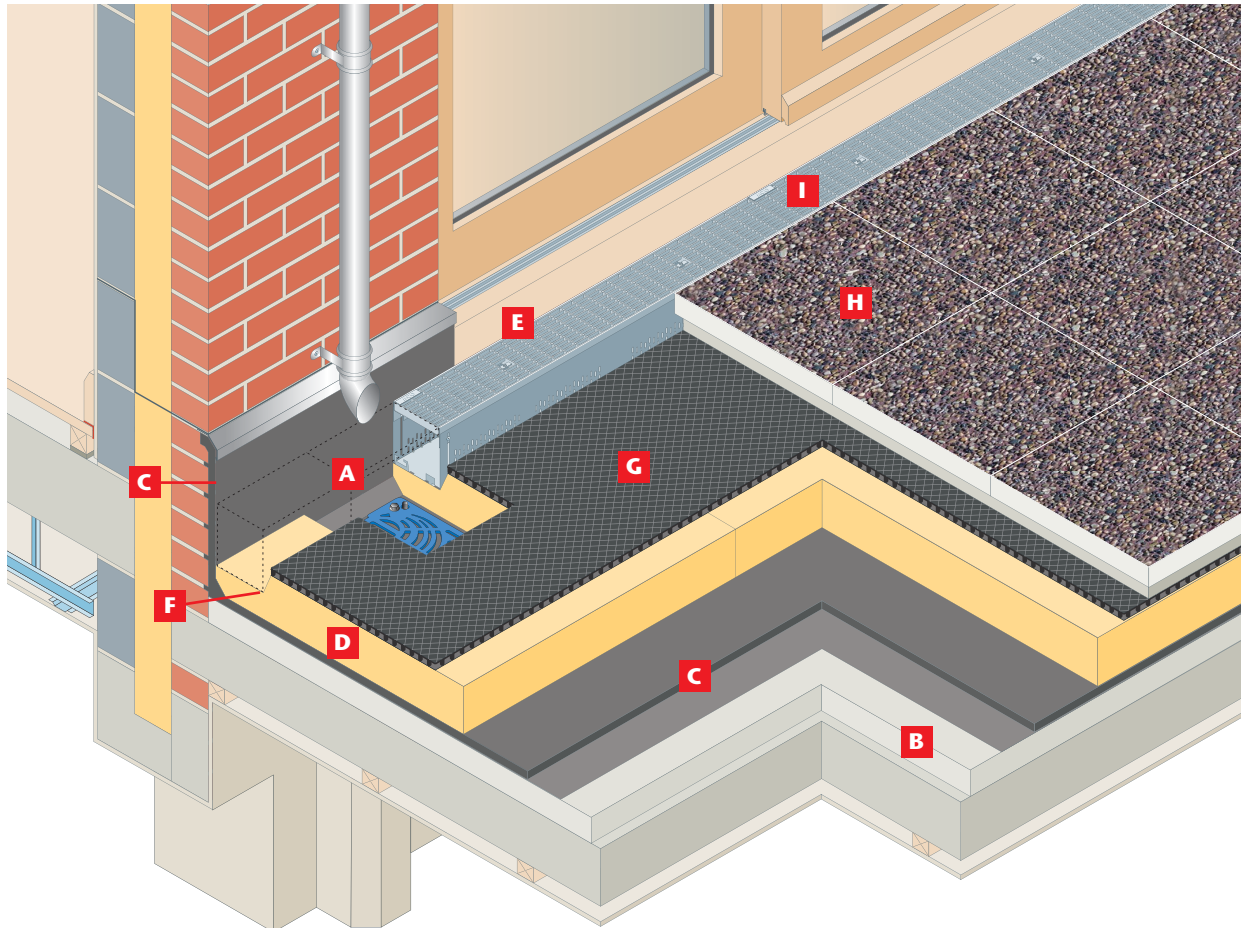

14



- | | | | | | |
|----------|--------------------------------------------------------------------------------------------|----------|-----------------------------------------------------------------------------------------------------------------------------------------------------------------------------|----------|----------------------------------------------------------------------|
| A | Form hole in deck and locate ACO Balcony Outlet to screed level. | D | Lay insulation board cut around outlet and flush to asphalt upstand. Ensure that insulation board is one course below cill regardless of overall board thickness specified. | F | Chamfer edge of insulation away from channel to improve percolation. |
| B | Lay screed to falls over structural slab. | | | G | Lay drainage mat. |
| C | Lay isolating layer and two coats of mastic asphalt keyed into brickwork and beneath cill. | E | Position Adjustable Channel and adjust to cill height. | H | Lay paving slabs on lean mix base. |
| | | | | I | Fit channel gratings and secure with lock screws provided. |

Installation

Warm roof podium deck

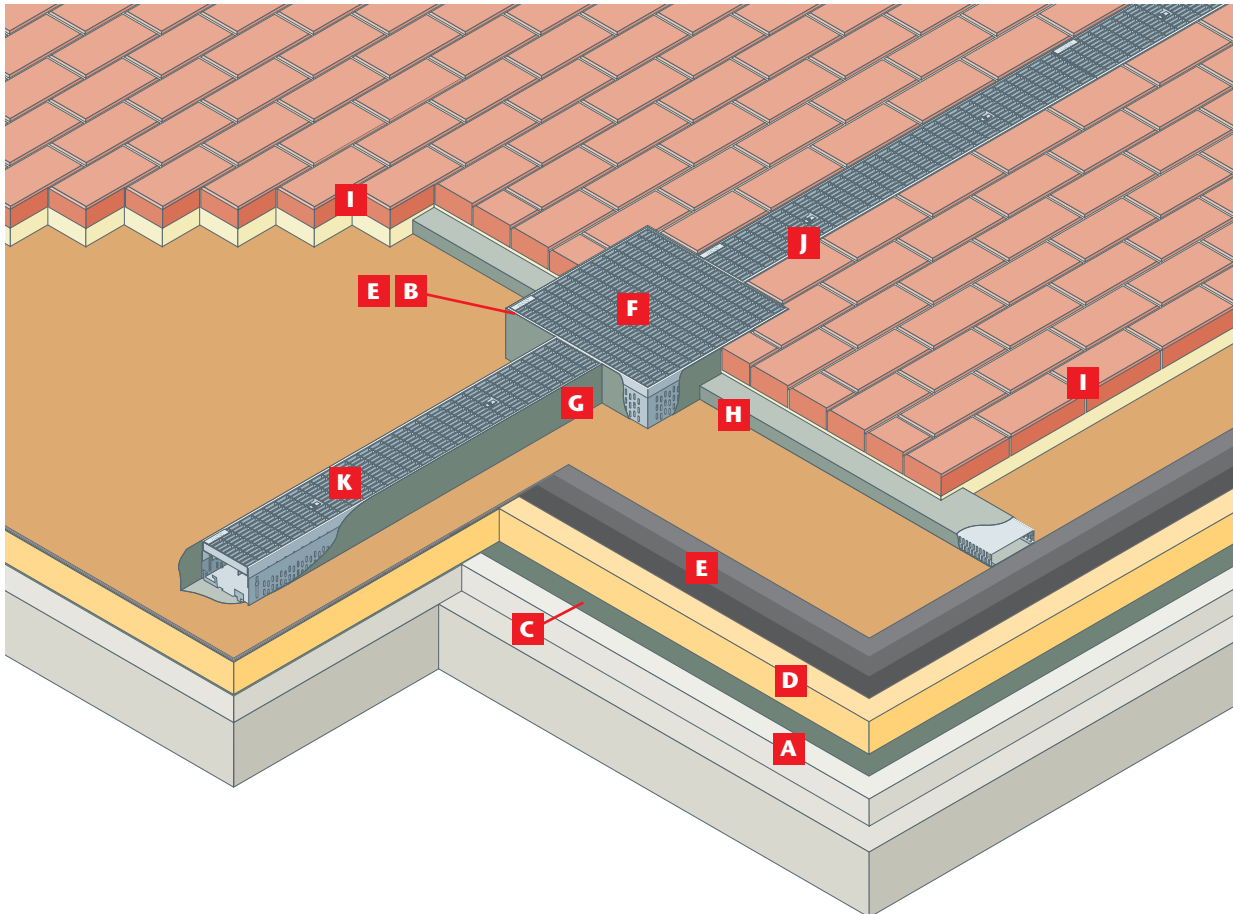

A Lay screed to falls over structural slab.

B Form hole in deck and locate ACO HP rainwater outlet level with surface of insulation (hidden detail).

C Lay vapour barrier.

D Lay and bond roofing grade insulation to vapour barrier.

E Lay and bond built up felt waterproofing to insulation and dress into outlet (hidden detail).

F Position height adjustable Access Grate and Frame over ACO rainwater outlet.

G Butt joint channels to Access Frame and wrap with geotextile filter membrane. Cut away filter membrane at butt joint to ensure free flow.

H Butt joint concealed Drainage Ducts to Access Frame and wrap with geotextile filter membrane. Cut away filter membrane at butt joint to ensure free flow.

I Prepare sharp sand bed and lay brick paviors.

J Adjust channel height to finished paved level.

K Fit channel gratings and secure with lock screws provided.

Installation

Inverted roof parapet terrace

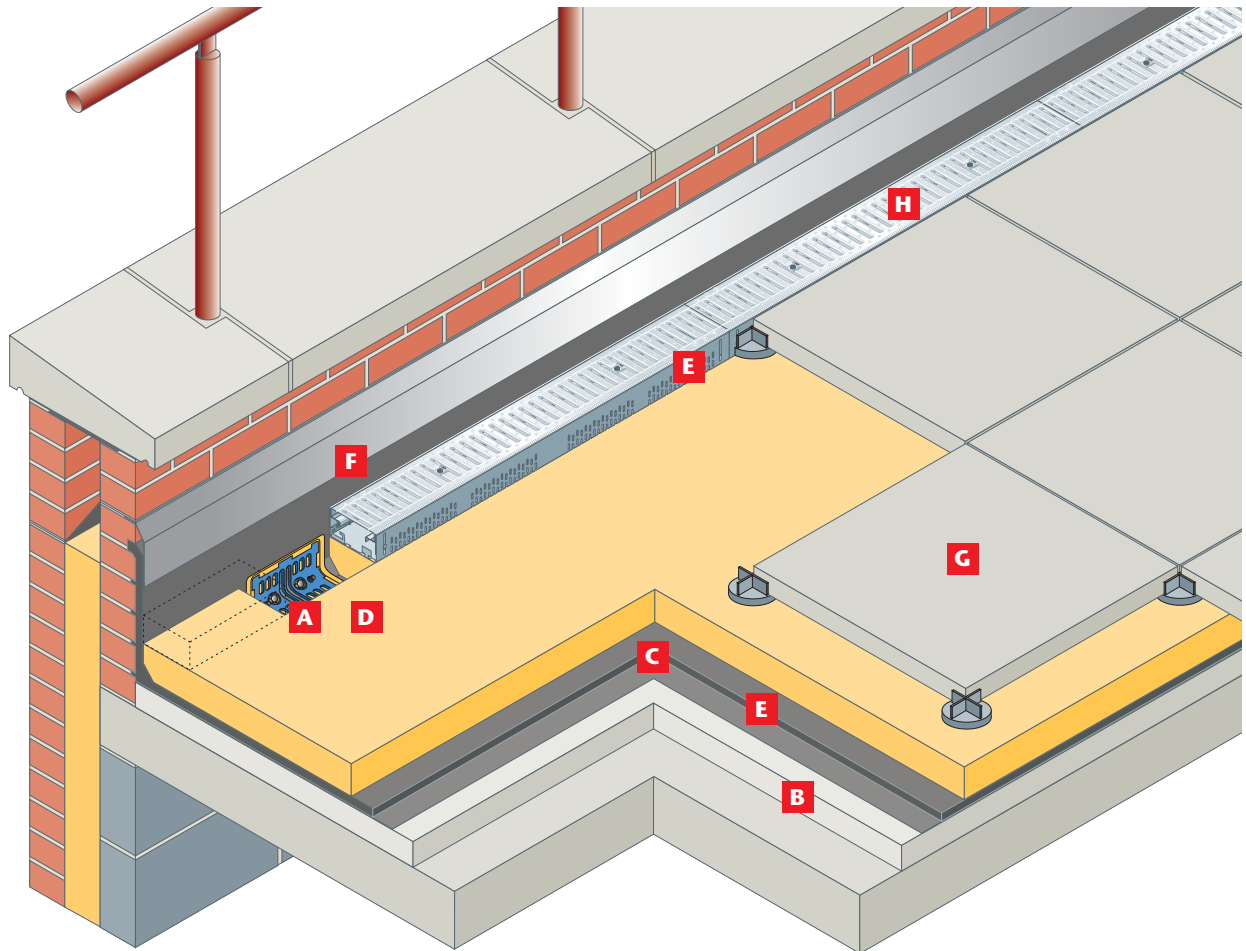

- A** Form hole in wall, position ACO Two Way outlet and connect pipework.
- B** Lay screed to falls over structural slab.
- C** Lay isolating layer and two coats of mastic asphalt keyed into brickwork and fitted with flashing.

- D** Lay insulation board cut around rainwater outlet and flush to asphalt upstand.
- E** Position appropriate channel to be laid level with combined depth of paving slabs on paving supports.

- F** Install channel flush to wall.
- G** Ballast insulation with paving slabs laid on supports.
- H** Fit channel gratings and secure with lock screws provided.